

Scherstabwägezelle SHEAR BEAM LOAD CELL

FTK



Nennlast: **500, 1000, 2000 kg**
3000, 5000 kg

Option:



OIML R60 C3 APPROVED
FTK 1000 to 5000 kg: OIML R60 C3 APPROVED

ATEX approved **Ex** II 1 G **Ex** II 2 D (zone 0-1-2-21-22)



-WÄGEZELLE aus Spezialstahl
Kombinierter Fehler $\pm 0,02\%$ F.S.
Schutzart IP 67/68
SPECIAL STEEL CONSTRUCTION
COMBINED ERROR $\pm 0,02\%$ F.S.
PROTECTION CLASS IP 67/68

verschweißt/
welded

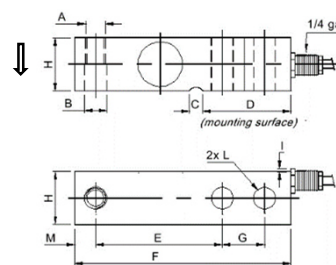

	500 1000 2000	3000 5000
A	M12 x 1.75	M20 x 2.5
B	Ø 13.5	Ø 22
C	8	6
D	53	74
E	76.2	95.3
F	130	171.5
G	25.4	38.1
H	32	38.1
I	2	2
L	Ø 13	Ø 20
M	12.6	19

Einbaumodule

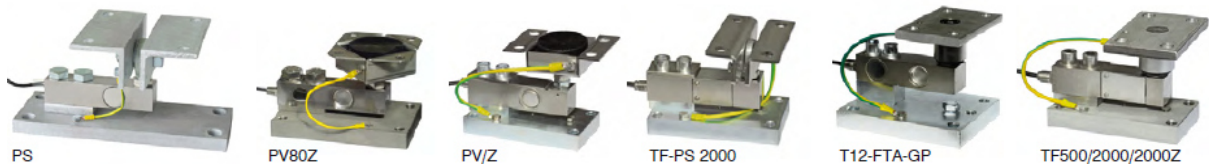

technical Features

technische Daten

Rated Output	2mV/V	Wägezellenspannung
Temperature Effect on Zero	0,0025%/°C	TK Nullpunkt
Temperature Effect on Span	0,0025%/°C	TK Bereich
Compensated Temperatur Range	-10°C +40°C	Nenntemperaturbereich
Operating Temperature Range	-30°C +40°C	Betriebstemperaturbereich
Input Resistance	380Ω	Input Resistance
Output Resistance	350Ω	Output Resistance
Zero Balance	+/- 2%	Zero Balance
Creep at nominal Load in 30 Minutes	0,03%	Kriechen bei Nennlast in 30 Minuten
DC Voltage Range	12-30VDC	DC-Spannungsbereich
Insulation Resistance	>2000MΩ	Isolationswiderstand
SAFE OVERLOAD (% of Full Scale)	150%	Überlastschutz (% vom Endwert)
ULTIMATE OVERLOAD (% of Full Scale)	>250%	Bruchlast (% vom Endwert)
Deflection at nominal Load	0,6mm	Nennmessweg

Cable		Kabel
Length	3m	Länge
Diameter	6mm	Ø
Cores	6x0,20mm ²	Adern

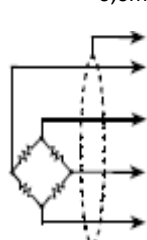

	Shield	Schirm
Signal +	green	Signal + green
Excitation +	rot	Speise + rot
Sense +	blau	Sense + blau
Signal -	white	Signal - weiss
Excitation -	black	Speise - schwarz
Sense -	yellow/brown	Sense - gelb/braun

Selbstzentrierende Lastfüße



PIEDINOSB2M8
M8x1.25

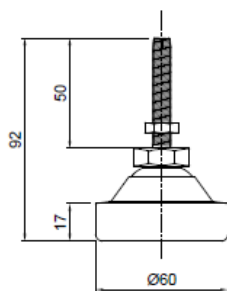

PIEDINOSB2M10
M10x1.5

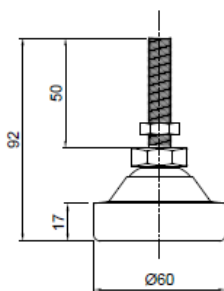

PIEDINOSB2INOX
M12x1.75

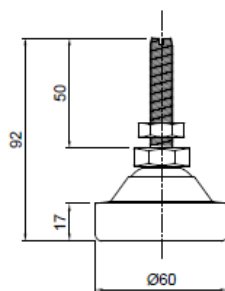

PIEDINOSB2M20
M20x2.5

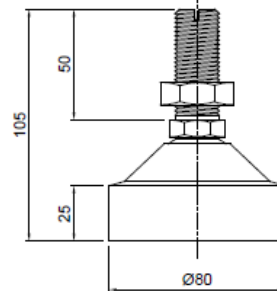

PIEDINOSB2ZNC
M12x1.75

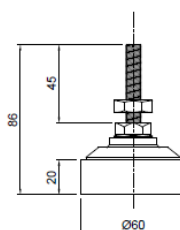

PIEDINOSB2ZNCM20
M20x2.5

